

COR 70 HIDDEN SASH TB

Transmittance

$U_w \geq 0.85$ (W/m²K)

Consult typology, dimensions and glass.

Acoustic insulation

Maximum glazing	40 mm
Minimum glazing	26 mm
Maximum acoustic insulation	Rw = 46 dB

Sightlines

Frame	70 mm
Sash	70 mm

Profile Thickness

Window	1.9 mm
--------	--------

Polyamide strip length 35 mm

Maximum sash dimensions

Standard solution

Width (L)	1,300 mm
Height (H)	2,400 mm

HD Hinges (side hung)

Width (L)	1,200 mm
Height (H)	3,500 mm

Consult maximum dimensions according to typologies.

Maximum sash weight 160 kg

Consult maximum weight according to typologies.

Categories achieved at test centre

Protection against atmospheric agents.

Air permeability

(UNE-EN 12207): Class 4

Watertightness

(UNE-EN 12208): Class E1650

Wind resistance

(UNE-EN 12210): Class C5

* Reference test 1.23 x 1.48 m / 1 sash.

Security test: PAS24 ☒

Passed

* Reference test 1.100 x 2.400 m / 1 sash.

Test verified by

ALUMINIOS CORTIZO S.A.U.

Extrusion alloy 6063 T-5

Finishes

Possibility of dual colour

Colour powder coating (RAL, mottled & rough)

According to Qualicoat >60 microns

Wood effect powder coating

According to Qualideco standard

Anodising

According to Ewwa Euras / Standard Class 15 / Optionally Class 20 and 25

Opening possibilities

Inward opening: 1 & 2 sash side hung, 1 & 2 sash tilt & turn, parallel sliding and bottom hung.

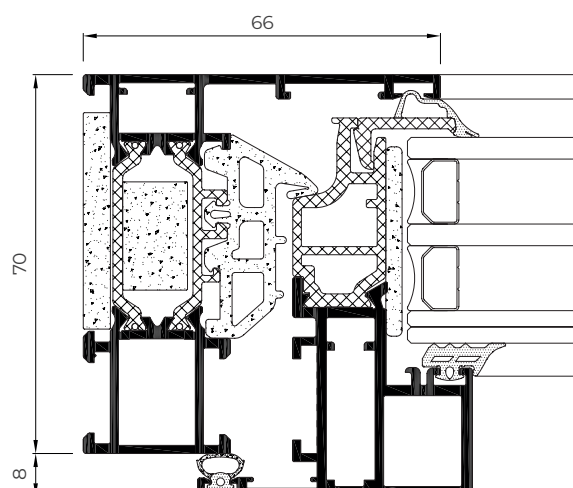

COR 70 HIDDEN SASH HALF-HIDDEN SOLUTION

Transmittance

$U_w \geq 0.84$ (W/m²K)

Consult typology, dimensions and glass.

Acoustic insulation

Maximum glazing	55 mm
Minimum glazing	6 mm
Maximum acoustic insulation	Rw = 44 dB

Sightlines

Frame	70 mm
Sash	78 mm

Profile Thickness

Window	1.5 mm
--------	--------

Polyamide strip length

32-35 mm

Maximum sash dimensions

Width (L) = 1,000 mm

Height (H) = 1,700 mm

Consult maximum dimensions according to typologies.

Maximum sash weight

160 kg

Consult maximum weight according to typologies.

Categories achieved at test centre

Protection against atmospheric agents.

Air permeability

(UNE-EN 12207): Class 4

Watertightness

(UNE-EN 12208): Class E1800

Wind resistance

(UNE-EN 12210): Class C5

* Reference test 1.23 x 1.48 m / 2 sashes

Security test: PAS24 ☒

Passed

* Reference test 1.100 x 2.400 m / 1 sash.

Test verified by

ALUMINIOS CORTIZO S.A.U.

Extrusion alloy

6063 T-5

Finishes

Possibility of dual colour

Colour powder coating (RAL, mottled & rough)

According to Qualicoat >60 microns

Wood effect powder coating

According to Qualideco standard

Anodising

According to Ewwa Euras / Standard Class 15 / Optionally Class 20 and 25

Opening possibilities

Inward opening: 1 & 2 sash side hung, 1 & 2 sash tilt & turn, parallel sliding and bottom hung.

